

IMPORTANT SAFETY AND INSTALLATION INSTRUCTIONS

WARNING: Risk of fire and electrical shock. This product is to be installed by a qualified electrician only.

CAUTION: When using electrical equipment, basic safety precautions should always be followed including the following: Read all instructions carefully before installation and save

for future use. Make sure installation and all connections are in accordance with National Electrical Code and any local regulations. To avoid possible electrical shock, be sure that the power supply is turned off before installing or servicing this fixture. Servicing should be performed by qualified service personnel.

These instructions do not claim to cover all details or variations. When additional information is desired, please contact your SPI representative.

LIGHTRUSS LED UPGRADE - DOWNLIGHT

STEP 1: Unpack LED Fixture. Remove Splice Covers. Remove Hanging Brackets.

****TIP:** Retain Hanging Brackets, Covers, and Screws for completion of installation.**

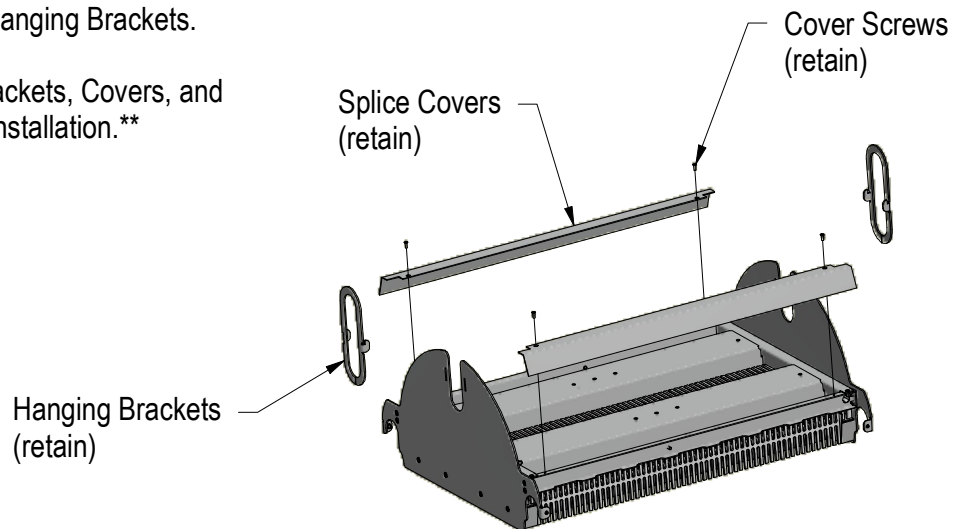

STEP 2: Dismantle Existing Fixture Unit. Remove Lamp, Ballast, and any Covers to exposed Supply Leads. Cut Supply Leads.

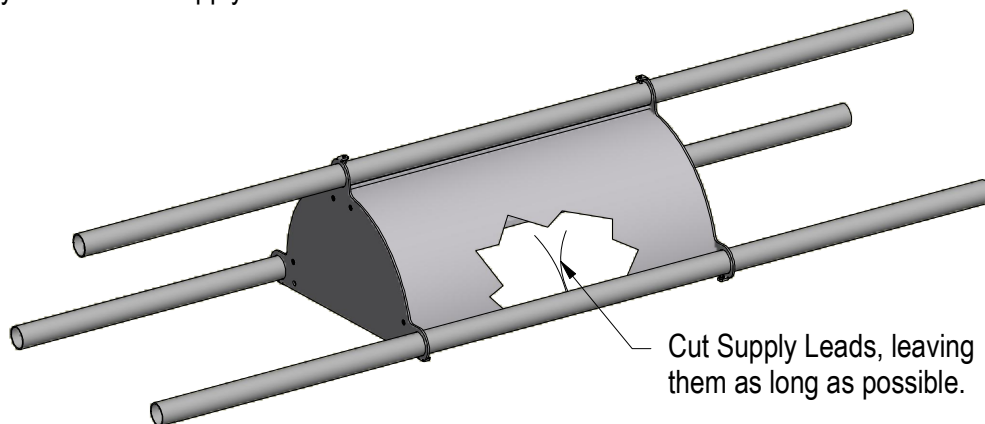

****Supply Leads may originate from either of the side tubes.****

Page 1

11/10/21
IS111503X

IMPORTANT SAFETY AND INSTALLATION INSTRUCTIONS

WARNING: Risk of fire and electrical shock. This product is to be installed by a qualified electrician only.

CAUTION: When using electrical equipment, basic safety precautions should always be followed including the following: Read all instructions carefully before installation and save

for future use. Make sure installation and all connections are in accordance with National Electrical Code and any local regulations. To avoid possible electrical shock, be sure that the power supply is turned off before installing or servicing this fixture. Servicing should be performed by qualified service personnel.

These instructions do not claim to cover all details or variations. When additional information is desired, please contact your SPI representative.

LIGHTRUSS LED UPGRADE - DOWNLIGHT

STEP 3 (OPTION A): Loosen Set Screws. Remove Housing End Plates from Fixture Housing. Discard Fixture Housing.

****TIP:** Impact driver will help loosen the flat head screws**

****TIP:** Hammer may be needed to break end plates from housing.**

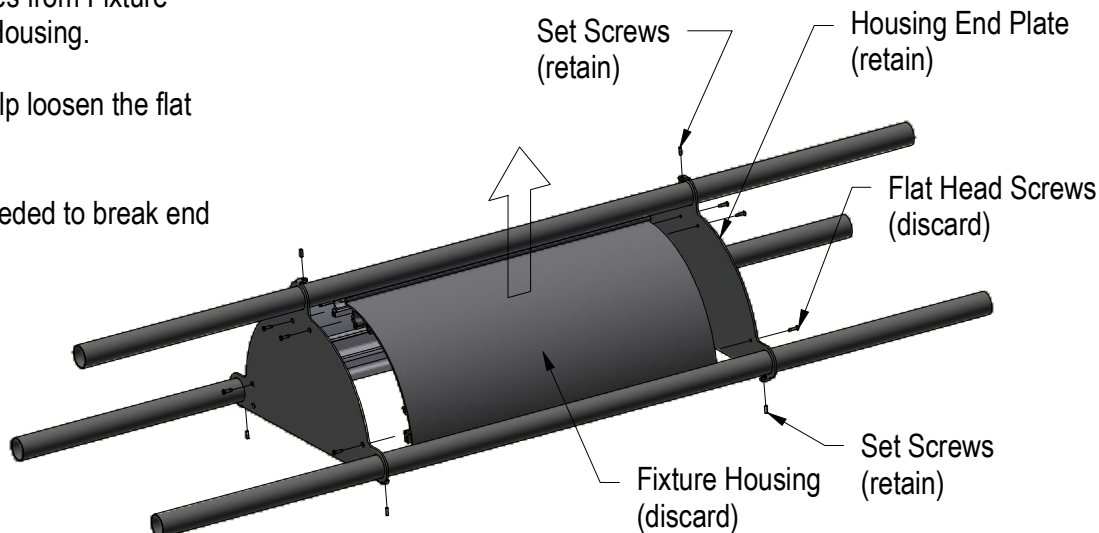

Choose between
OPTION A or OPTION B

OPTION A: RETAIN END PLATES (NO CUTTING)

OPTION B: CUT OUT OLD HOUSING AND END PLATE

STEP 3 (OPTION B): Cut out Fixture Housing.

****TIP:** Protect truss tube from being damaged during cutting.**

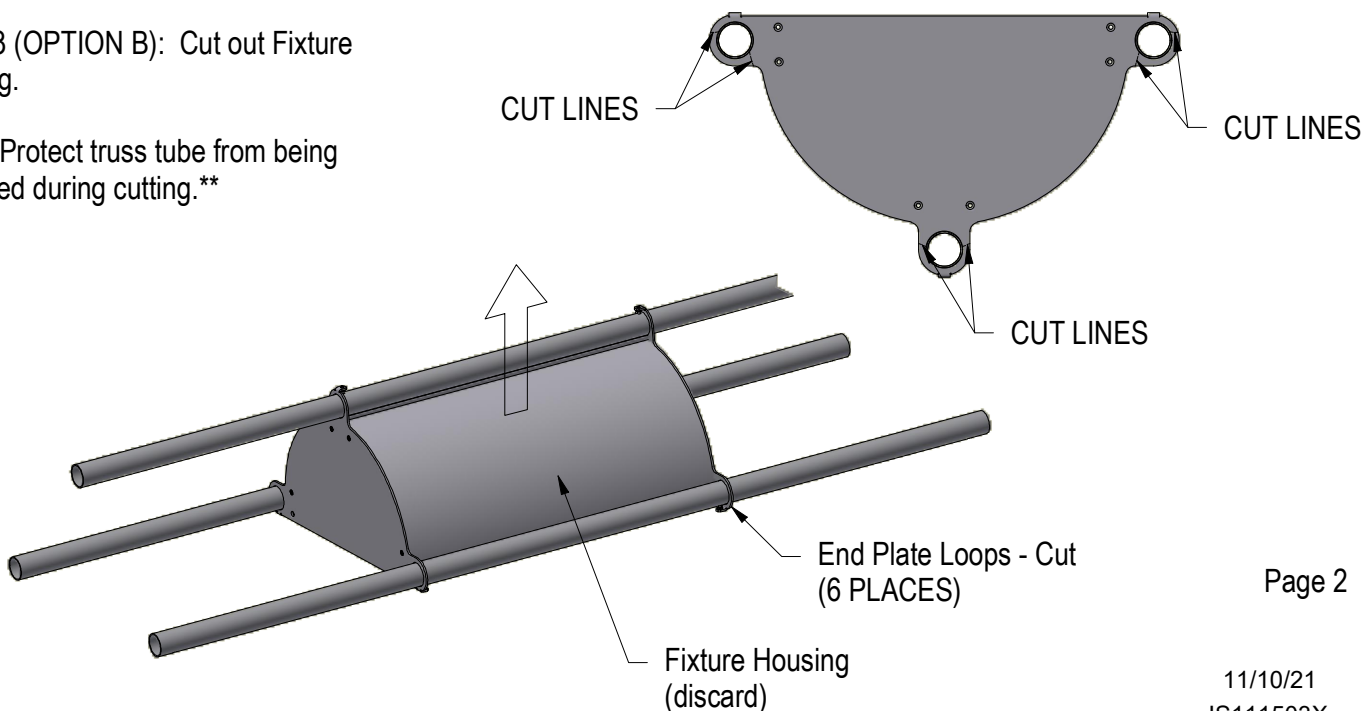

IMPORTANT SAFETY AND INSTALLATION INSTRUCTIONS

WARNING: Risk of fire and electrical shock. This product is to be installed by a qualified electrician only.

CAUTION: When using electrical equipment, basic safety precautions should always be followed including the following: Read all instructions carefully before installation and save

for future use. Make sure installation and all connections are in accordance with National Electrical Code and any local regulations. To avoid possible electrical shock, be sure that the power supply is turned off before installing or servicing this fixture. Servicing should be performed by qualified service personnel.

These instructions do not claim to cover all details or variations. When additional information is desired, please contact your SPI representative.

LIGHTRUSS LED UPGRADE - DOWNLIGHT

STEP 4 (OPTION A): Rest new LED Fixture onto truss in desired location.

****TIP:** Make sure orientation of fixture light output is facing the correct direction.**

****TIP:** Position top tube of truss in slot first, and then rotate fixture into position.

****TIP:** Fixture location may be adjusted along truss as long as supply lead wires exit truss within fixture.**

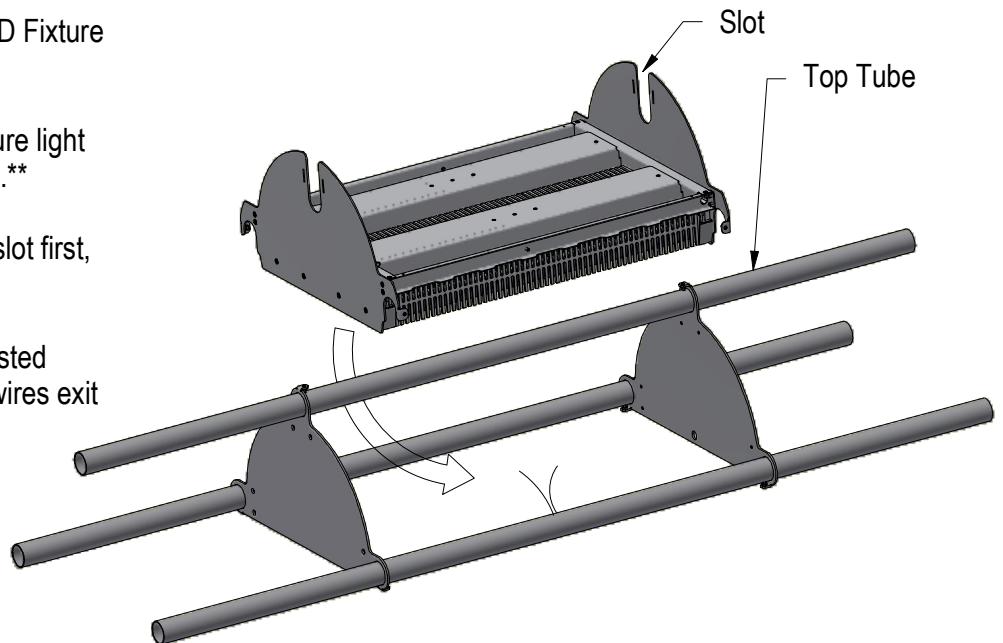

OPTION A: RETAIN END PLATES (NO CUTTING)

OPTION B: CUT OUT OLD HOUSING AND END PLATE

STEP 4 (OPTION B): Rest new LED Fixture onto truss in desired location.

****TIP:** Make sure orientation of fixture light output is facing the correct direction.**

****TIP:** Position top tube of truss in slot first, and then rotate fixture into position.

****TIP:** Fixture location may be adjusted along truss as long as supply lead wires exit truss within fixture.**

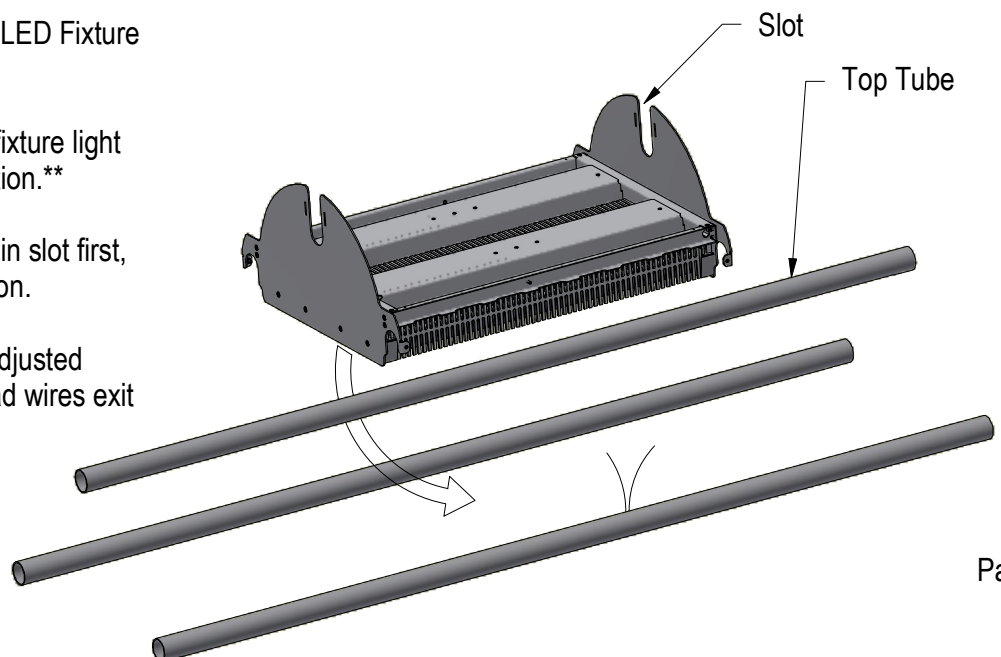

IMPORTANT SAFETY AND INSTALLATION INSTRUCTIONS

WARNING: Risk of fire and electrical shock. This product is to be installed by a qualified electrician only.

CAUTION: When using electrical equipment, basic safety precautions should always be followed including the following: Read all instructions carefully before installation and save

for future use. Make sure installation and all connections are in accordance with National Electrical Code and any local regulations. To avoid possible electrical shock, be sure that the power supply is turned off before installing or servicing this fixture. Servicing should be performed by qualified service personnel.

These instructions do not claim to cover all details or variations. When additional information is desired, please contact your SPI representative.

LIGHTRUSS LED UPGRADE - DOWNLIGHT

STEP 5 (OPTION A): Lock LED Fixture to truss by tightening Side Set Screws. Slide old Housing End Plates over to LED fixture and secure with set screws.

****TIP:** Side Set Screws are used to ground fixture. Tighten to break through paint on tube.**

****TIP:** Discard Hanging Brackets from Step 1. (not used for Option A)**



Hanging Brackets
(discard)

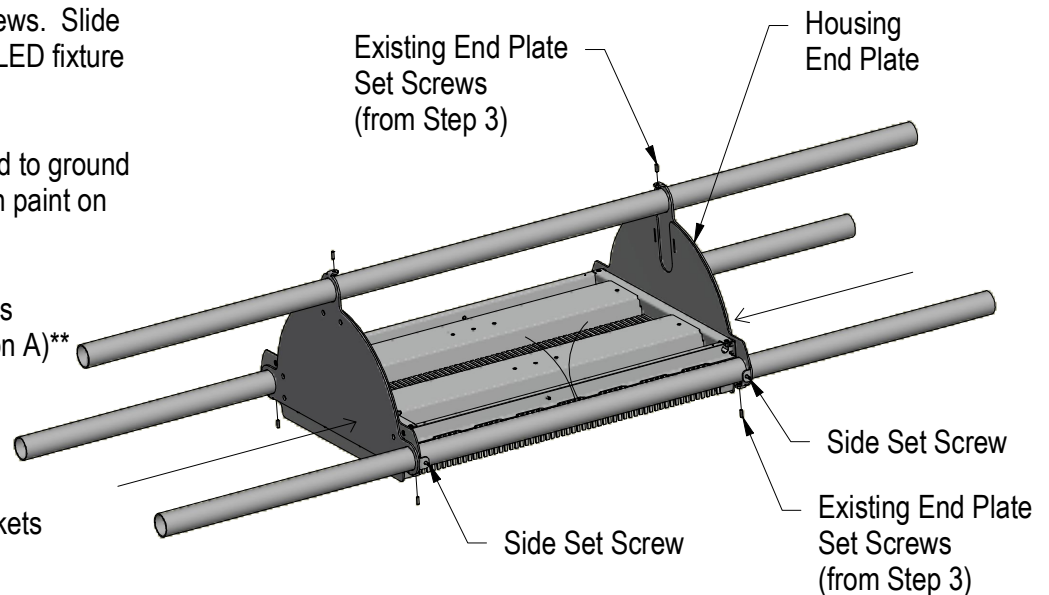

OPTION A: RETAIN END PLATES (NO CUTTING)

OPTION B: CUT OUT OLD HOUSING AND END PLATE

STEP 5 (OPTION B): Twist Hanging Brackets onto top tube with tabs facing LED Fixture. Slide Mounting Brackets to LED fixture and insert tab into slot. Lock LED Fixture to truss by tightening Side Set Screws.

****TIP:** Side Set Screws are used to ground fixture. Tighten to break through paint on tube.**

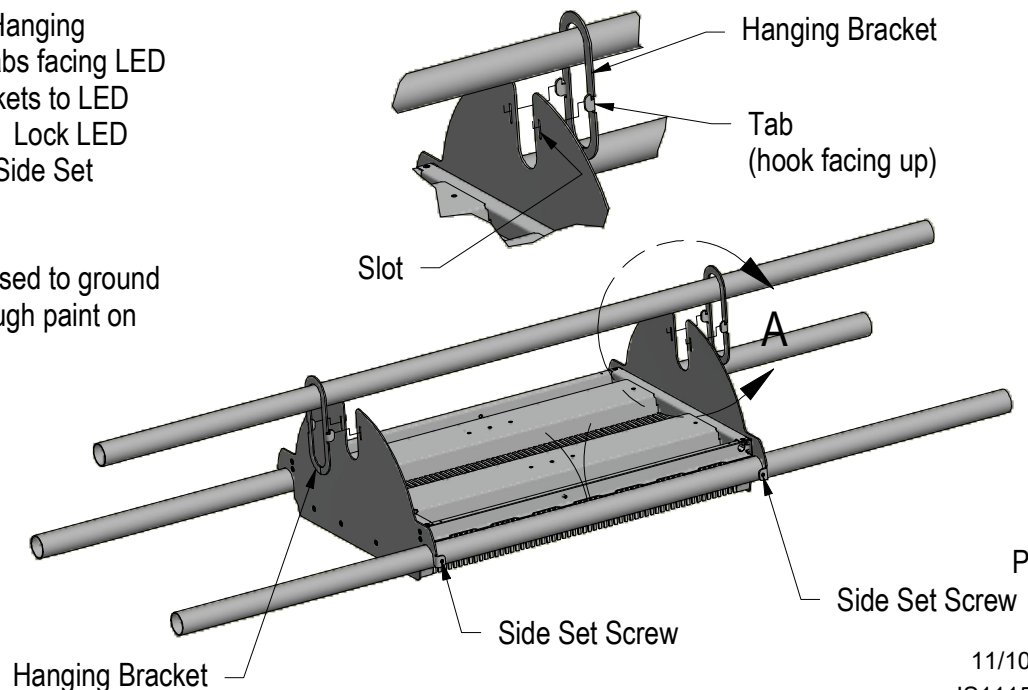

Page 4

11/10/21
IS111503X

IMPORTANT SAFETY AND INSTALLATION INSTRUCTIONS

WARNING: Risk of fire and electrical shock. This product is to be installed by a qualified electrician only.

CAUTION: When using electrical equipment, basic safety precautions should always be followed including the following: Read all instructions carefully before installation and save

for future use. Make sure installation and all connections are in accordance with National Electrical Code and any local regulations. To avoid possible electrical shock, be sure that the power supply is turned off before installing or servicing this fixture. Servicing should be performed by qualified service personnel.

These instructions do not claim to cover all details or variations. When additional information is desired, please contact your SPI representative.

LIGHTRUSS LED UPGRADE - DOWNLIGHT

STEP 6 (OPTION A and B): Wire LED Fixture to Supply Leads.

****TIP:** Supply Leads may originate from either of the side tubes.**

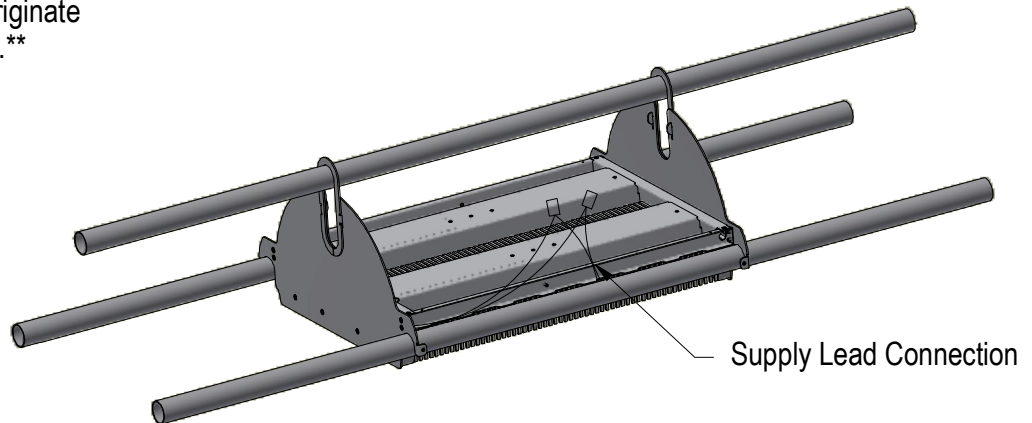

STEP 7 (OPTION A and B): Replace Splice Covers.

